

GXL-CUY Stainless Steel Handle

Material

- Stainless steel 303, mirror and satin combination finish

Parts Included

- Raised countersunk head tapping screw 4x20 (SUS)

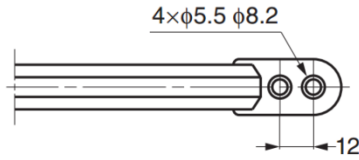

GXL-CUY240TT
GXL-CUY260TT

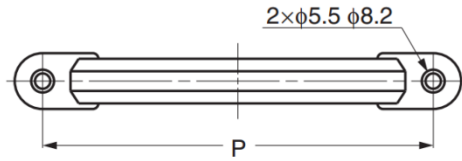

GXL-CUY120TT
GXL-CUY140TT
GXL-CUY160TT
GXL-CUY190TT

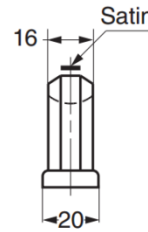
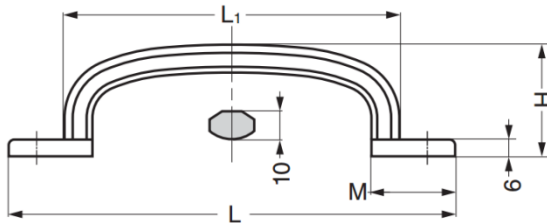

Part No.	L	L ₁	H	M	P
GXL-CUY120TT	118	80	36	30	100
GXL-CUY140TT	138	100	38		120
GXL-CUY160TT	158	120	40		140
GXL-CUY190TT	188	150	42		170
GXL-CUY240TT	238	180	44	40	196
GXL-CUY260TT	258	200	46		216